

ROHAN Upavan

L - WING



Note: The layout and landscape features are based on preliminary design prepared by architects & may change during final design and construction.





Area statement (sq.ft.)

Flat No.	BHK Type	Carpet Area	Carpet Area+ Balcony+Utility	Garden Area	Super Built Up Area
L - 101	2 BHK - Type 1	622	686	236	1,068
L - 102	1 BHK	418	449	-	621
L - 103	2 BHK - Type 1	627	684	-	947
L - 104	2 BHK - Type 1	627	684	-	947
L - 106	2 BHK - Type 2	714	783	64	1,117
L - 107	2 BHK - Type 1	617	676	-	937
L - 108	2 BHK - Type 1	625	689	102	1,006

1 sqmt = 10.764 sqft.





Area statement (sq.ft.)

Flat No.	BHK Type	Carpet Area	Carpet Area+ Balcony+Utility	Super Built Up Area
L - 201	2 BHK - Type 1	622	681	943
L - 202	1 BHK	418	449	621
L - 203	2 BHK - Type 1	627	684	947
L - 204	2 BHK - Type 1	627	684	947
L - 206	2 BHK - Type 2	714	778	1,077
L - 207	2 BHK - Type 1	617	676	937
L - 208	2 BHK - Type 1	625	684	948

1 sqmt = 10.764 sqft.





Area statement (sq.ft.)

Flat No.	BHK Type	Carpet Area	Carpet Area+ Balcony+Utility	Super Built Up Area
L - 301	2 BHK - Type 1	622	681	943
L - 302	1 BHK	418	449	621
L - 303	2 BHK - Type 1	627	684	947
L - 304	2 BHK - Type 1	627	684	947
L - 305	2 BHK - Type 2	716	780	1,080
L - 306	2 BHK - Type 2	714	778	1,077
L - 307	2 BHK - Type 1	617	676	937
L - 308	2 BHK - Type 1	625	684	948

1 sqmt = 10.764 sqft.





Area statement (sq.ft.)

Flat No.	BHK Type	Carpet Area	Carpet Area+ Balcony+Utility	Super Built Up Area
L - 401 to L 501	2 BHK - Type 1	622	681	943
L - 402 to L 502	1 BHK	418	449	621
L - 403 to L 503	2 BHK - Type 1	627	684	947
L - 404 to L 504	2 BHK - Type 1	627	684	947
L - 405 to L 505	2 BHK - Type 2	716	780	1,080
L - 406 to L 506	2 BHK - Type 2	714	778	1,077
L - 407 to L 507	2 BHK - Type 1	617	676	937
L - 408 to L 508	2 BHK - Type 1	625	684	948

1 sqmt = 10.764 sqft.





Area statement (sq.ft.)

Flat No.	BHK Type	Carpet Area	Carpet Area+ Balcony+Utility	Super Built Up Area
L - 601 to L 1001	2 BHK - Type 1	622	681	943
L - 602 to L 1002	1 BHK	418	449	621
L - 603 to L 1003	2 BHK - Type 1	637	694	961
L - 604 to L 1004	2 BHK - Type 1	637	694	961
L - 605 to L 1005	2 BHK - Type 2	716	780	1,080
L - 606 to L 1006	2 BHK - Type 2	714	778	1,077
L - 607 to L 1007	2 BHK - Type 1	617	676	937
L - 608 to L 1008	2 BHK - Type 1	625	684	948

1 sqmt = 10.764 sqft.



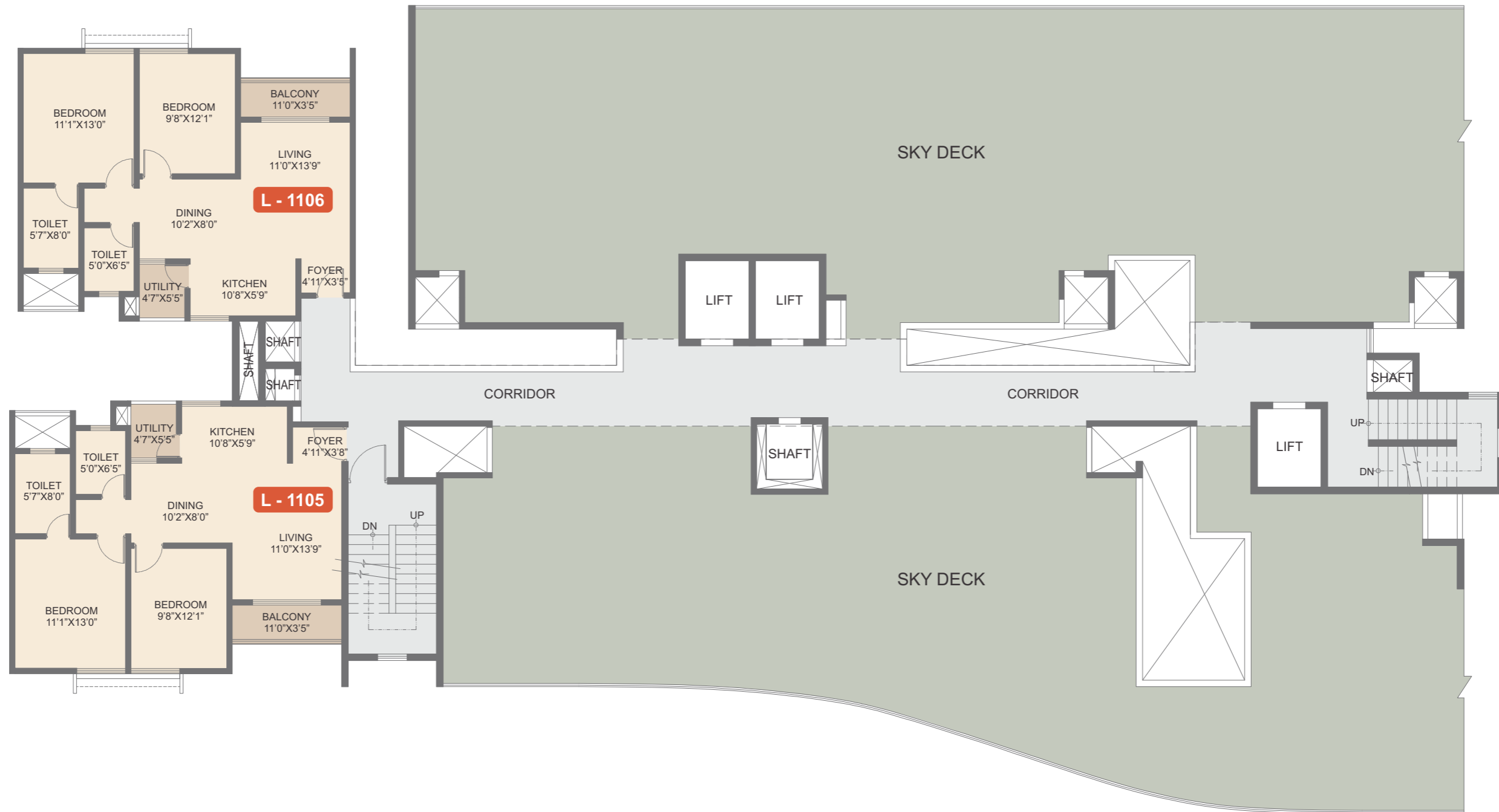

Area statement (sq.ft.)

Flat No.	BHK Type	Carpet Area	Carpet Area+ Balcony+Utility	Super Built Up Area
L-1105	2 BHK - Type 2	716	780	1,080
L-1106	2 BHK - Type 2	714	778	1,077

1 sqmt = 10.764 sqft.





Area statement (sq.ft.)

Flat No.	BHK Type	Carpet Area	Carpet Area+ Balcony+Utility	Super Built Up Area
L-1205	2 BHK - Type 2	716	780	1,080
L-1206	2 BHK - Type 2	714	778	1,077

1 sqmt = 10.764 sqft.



Area statement (sq.ft.)

Flat No.	BHK Type	Carpet Area	Carpet Area+ Balcony+Utility	Open Terrace Area	Super Built Up Area
L-1301	2 BHK - Type 1	638	704	282	1,116
L-1302	1 BHK	429	465	184	736
L-1303	2 BHK - Type 1	663	728	423	1,219
L-1304	2 BHK - Type 1	648	723	78	1,040
L-1305	2 BHK - Type 2	716	780	-	1,080
L-1306	2 BHK - Type 2	714	778	-	1,077
L-1307	2 BHK - Type 1	639	704	280	1,115
L-1308	2 BHK - Type 1	647	712	280	1,126

1 sqmt = 10.764 sqft.





Area statement (sq.ft.)

Flat No.	BHK Type	Carpet Area	Carpet Area+ Balcony+Utility	Super Built Up Area
L - 1401 to L 1501	2 BHK - Type 1	622	683	946
L - 1402 to L 1502	1 BHK	423	454	629
L - 1403 to L 1503	2 BHK - Type 1	646	706	977
L - 1404 to L 1504	2 BHK - Type 1	640	700	968
L - 1405 to L 1505	2 BHK - Type 2	716	780	1,080
L - 1406 to L 1506	2 BHK - Type 2	714	778	1,077
L - 1407 to L 1507	2 BHK - Type 1	623	683	946
L - 1408 to L 1508	2 BHK - Type 1	630	690	956

1 sqmt = 10.764 sqft.





Area statement (sq.ft.)

Flat No.	BHK Type	Carpet Area	Carpet Area+ Balcony+Utility	Super Built Up Area
L-1601	2 BHK - Type 1	622	683	946
L-1602	1 BHK	423	454	629
L-1603	2 BHK - Type 1	646	706	977
L-1604	2 BHK - Type 1	640	714	989
L-1605	2 BHK - Type 2	716	780	1,080
L-1606	2 BHK - Type 2	714	778	1,077
L-1607	2 BHK - Type 1	623	697	967
L-1608	2 BHK - Type 1	630	690	956

1 sqmt = 10.764 sqft.





Area statement (sq.ft.)

Flat No.	BHK Type	Carpet Area	Carpet Area+ Balcony+Utility	Super Built Up Area
L-1701	2 BHK - Type 1	622	683	946
L-1702	1 BHK	423	454	629
L-1703	2 BHK - Type 1	647	721	998
L-1704	2 BHK - Type 1	659	757	1,048
L-1705	2 BHK - Type 2	716	780	1,080
L-1706	2 BHK - Type 2	714	778	1,077
L-1707	2 BHK - Type 1	642	740	1,025
L-1708	2 BHK - Type 1	631	705	977

1 sqmt = 10.764 sqft.





Area statement (sq.ft.)

Flat No.	BHK Type	Carpet Area	Carpet Area+ Balcony+Utility	Open Terrace Area	Super Built Up Area
L-1801	2 BHK - Type 1	622	683	-	946
L-1802	1 BHK	423	454	-	629
L-1803	2 BHK - Type 1	665	763	-	1,057
L-1804	2 BHK - Type 1	659	714	-	988
L-1805	2 BHK - Type 2	723	841	62	1,196
L-1806	2 BHK - Type 2	714	778	-	1,077
L-1807	2 BHK - Type 1	642	697	-	966
L-1808	2 BHK - Type 1	650	748	-	1,036

1 sqmt = 10.764 sqft.





Area statement (sq.ft.)

Flat No.	BHK Type	Carpet Area	Carpet Area+ Balcony+Utility	Open Terrace Area	Super Built Up Area
L-1901	2 BHK - Type 1	622	683	-	946
L-1902	1 BHK	423	454	-	629
L-1903	2 BHK - Type 1	665	720	-	997
L-1905	2 BHK - Type 2	716	742	38	1,047
L-1906	2 BHK - Type 2	750	776	90	1,120
L-1908	2 BHK - Type 1	650	705	-	976

1 sqmt = 10.764 sqft.

